

Elevations are for illustrative purposes only.

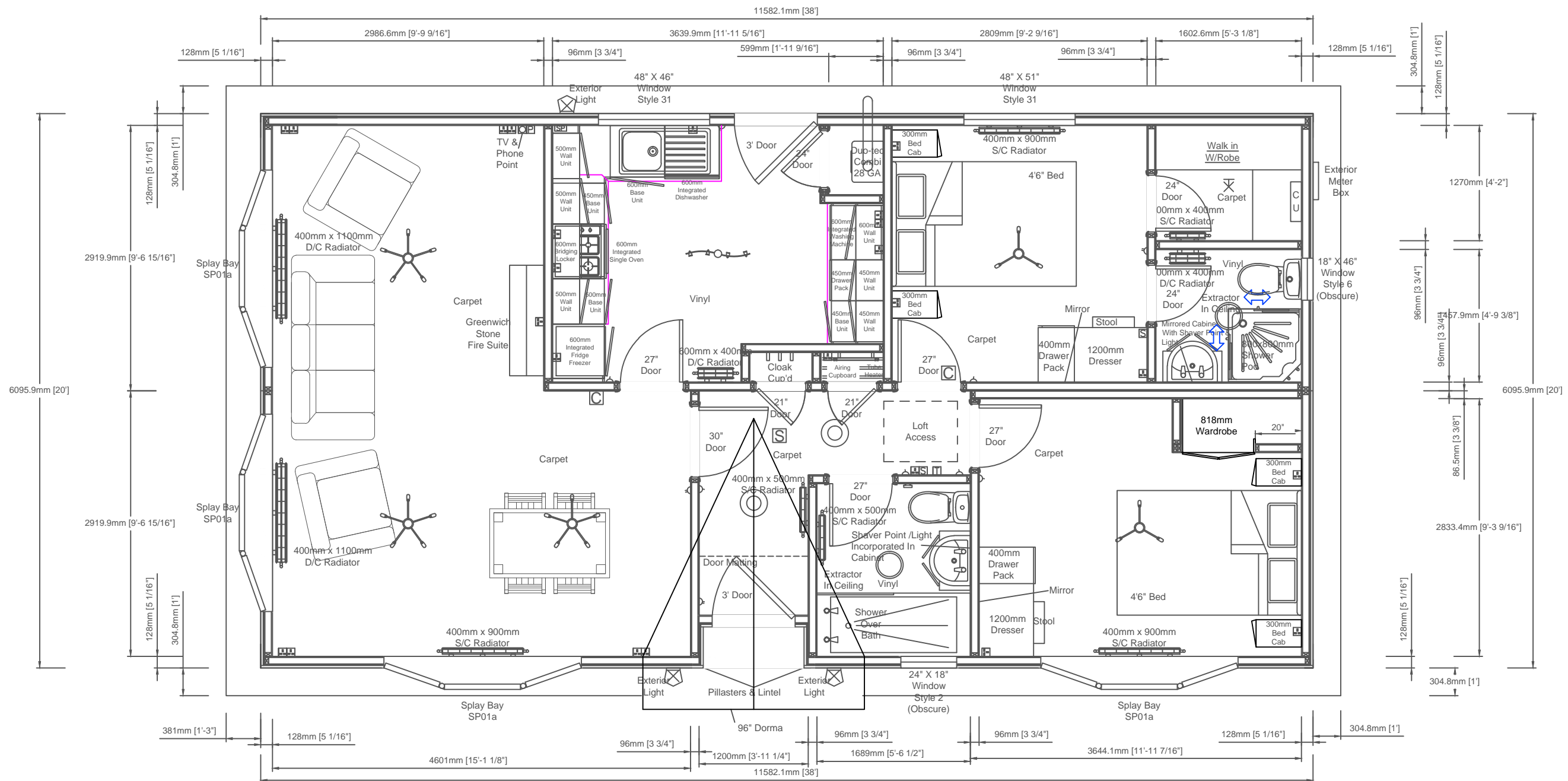

Room Sizes		
Rooms	Length	Width
Lounge/ Diner	15'1"	19'2"
Kitchen	12'	9'4"
Bathroom	5'7"	6'7"
Ensuite	4'10"	4'4"
WIW	4'2"	4'4"
Bedroom 1	9'3"	9'4"
Bedroom 2	12'1"	9'4"



Unit 4, Pychley Lodge Road Industrial Estate, Kettering, Northants NN15 6JQ  
 Tel: 01536 518513 Fax: 01536 523438  
 Email: sales@prestigeparkandleisurehomes.com  
 Visit our website: www.prestigeparkandleisurehomes.com

**Sonata II 38' x 20' (11.58m x 6.09m)**  
 2 Double Bedroom, En-Suite, WIW

Customers Signature; \_\_\_\_\_  
 Date; \_\_\_\_\_

Date: \_\_\_\_\_  
 Scale: Relative  
 Drawn: \_\_\_\_\_  
 Code: \_\_\_\_\_  
 Dwg No: \_\_\_\_\_  
 Serial No: \_\_\_\_\_

This home is designed in accordance with BS3632

**Legend**

△	Light Switch	+	Exterior Tap
○	Pull Card Switch	□	TV Point
⊥	Batten Holder	□	Phone Point
⊙	Globe Light	⊠	HDMI Point
⊗	Exterior Light	⊞	Thermostat
⊛	Downlight	⊞	CO <sub>2</sub> Alarm
⊞	Single Socket	⊞	Smoke Alarm
⊞	Double Socket	⊞	Radiator
⊞	Spur Socket	⊞	Consumer Unit
⊞	Switching Plate	⊞	Exterior Meter Box

Rev	Date	By	Description

Notes;

This plan is a guide and should be used for illustrative purposes only